



70 Keble Park North

Bishopthorpe, York, YO23 2SX

£1,100 PCM

*Fees apply

Bishopthorpe Village | Two Bedrooms | Dining Kitchen | First floor Bathroom | Rear Garden | Close to local amenities | Available mid/late September | Pets considered | Parking space | EPC Rating D | Council tax band B

- Smart mid terrace property
- Dining kitchen
- Two bedrooms
- Modern bathroom
- Enclosed private garden
- Available September
- Pets considered
- Bishopthorpe Village

Viewing

Please contact our Quantum Estate Agency Lettings Office on 01904 631631 if you wish to arrange a viewing appointment for this property or require further information.



2



1



1



D

To Let

Energy Efficiency Rating

	Current	Potential
Very energy efficient - lower running costs		
(92 plus) A		87
(81-91) B		
(69-80) C		
(55-68) D	63	
(39-54) E		
(21-38) F		
(1-20) G		
Not energy efficient - higher running costs		

England & Wales

EU Directive
2002/91/EC



Environmental Impact (CO₂) Rating

	Current	Potential
Very environmentally friendly - lower CO2 emissions		
(92 plus) A		86
(81-91) B		
(69-80) C		
(55-68) D	59	
(39-54) E		
(21-38) F		
(1-20) G		

England & Wales

EU Directive
2002/91/EC

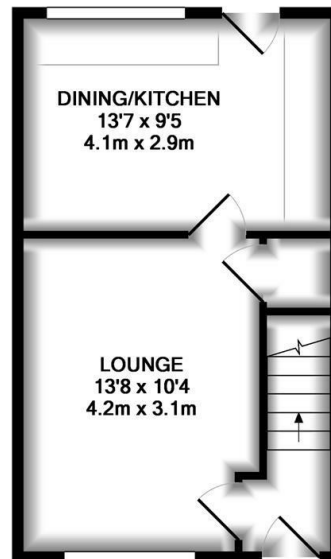

GROUND FLOOR

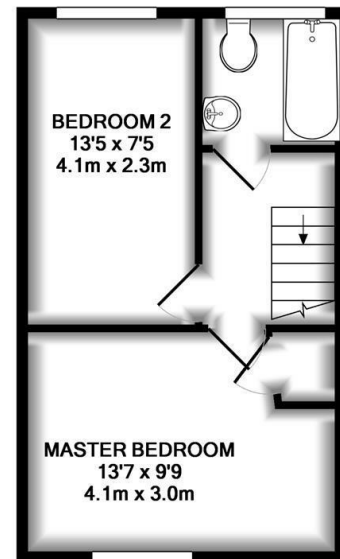

1ST FLOOR

Whilst every attempt has been made to ensure the accuracy of the floor plan contained here, measurements of doors, windows, rooms and any other items are approximate and no responsibility is taken for any error, omission, or mis-statement. This plan is for illustrative purposes only and should be used as such by any prospective purchaser. The services, systems and appliances shown have not been tested and no guarantee as to their operability or efficiency can be given.
Made with Metropix ©2018

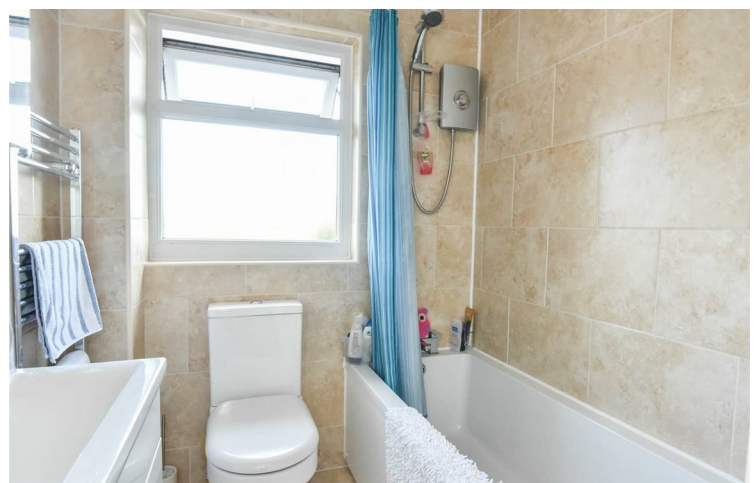

6 Walmgate, York, YO1 9TJ

t: 01904 631631 e: homes@quantumstateagency.com www.quantumstateagency.com

These particulars, whilst believed to be accurate are set out as a general outline only for guidance and do not constitute any part of an offer or contract. Intending purchasers should not rely on them as statements of or representation of fact (especially if a substantial journey is required to view the property), but must satisfy themselves by inspection or otherwise as to their accuracy. No person in this firm's employment has the authority to make or give any representation or warranty in respect of the property.